



MAKE WORK  
LIFE EASIER

A close-up photograph of a person's hands wearing grey work gloves, holding a black and blue Arc M Universal System torch. The person is wearing a blue shirt. The background is blurred.

# Set-Up Guide

## Arc M Universal System

**INTELLIGENT**  
TORCH SOLUTIONS

# Universal System-Small Housing

Tweco®, Miller®, LPB and LPW Connection



MAKE WORK  
LIFE EASIER

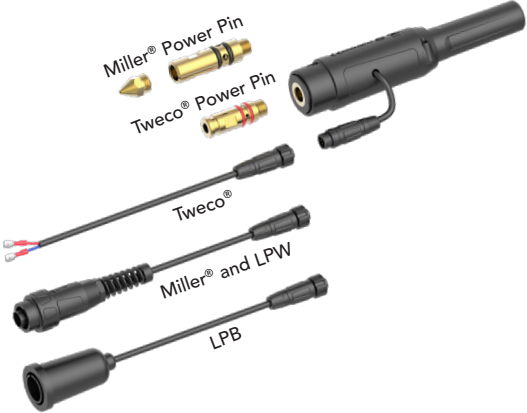

The system is built with a common gun plug connector, allowing all rear-ends to interchange seamlessly without requiring any special tools

## Uni to Lincoln® Connection

### 1-3

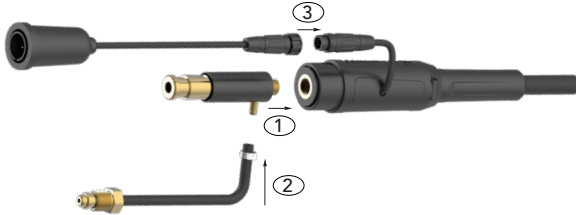

1. Assemble Lincoln® Power Pin
2. Assemble Lincoln® Gas Tube Assembly
3. Connect Quick Fit Assembly

### 4



4. Complete Lincoln® Connection

## Uni to Panasonic® Connection

### 1-3

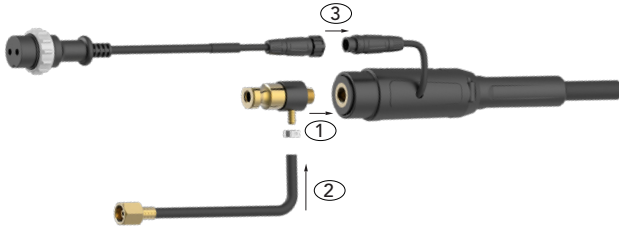

1. Assemble Panasonic® Power Pin
2. Assemble Panasonic® Gas Tube Assembly
3. Connect Quick Fit Assembly

### 4



4. Complete Panasonic® Connection

## Uni to Euro® Connection

### 1-2

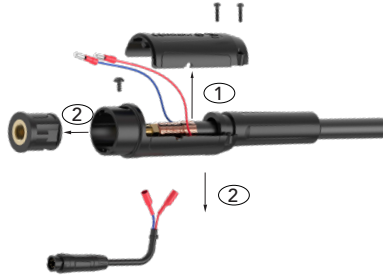

1. Open Rear End Housing
2. Remove Gun Plug Body and Male Switch Wire Plug

### 3-5

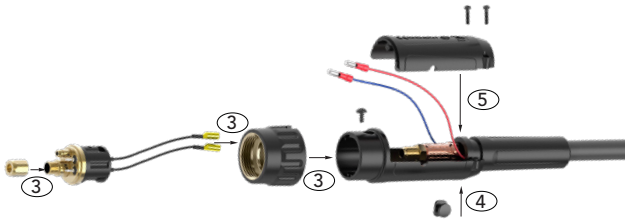

3. Assemble Liner Retaining Nut and Hybrid Gun Plug Body and Gun Plug Nut
4. Assemble Housing Stopper
5. Assemble Housing

### 6



6. Complete Euro® Connection

# Universal System-Large Housing

Tweco®, Miller®, LPB and LPW Connection



MAKE WORK  
LIFE EASIER

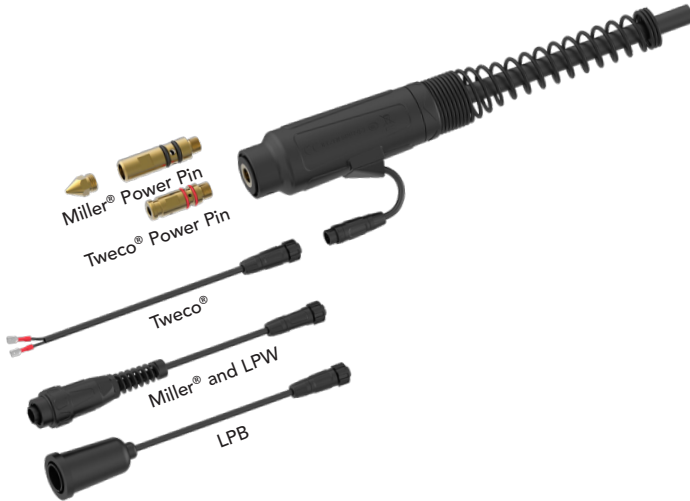

The system is built with a common gun plug connector, allowing all rear-ends to interchange seamlessly without requiring any special tools

## Uni to Lincoln® Connection

### 1-3



1. Assemble Lincoln® Power Pin
2. Assemble Lincoln® Gas Tube Assembly
3. Connect Quick Fit Assembly

### 4



4. Complete Lincoln® Connection

## Uni to Panasonic® Connection

### 1-3



1. Assemble Panasonic® Power Pin
2. Assemble Panasonic® Gas Tube Assembly
3. Connect Quick Fit Assembly

### 4



4. Complete Panasonic® Connection



## Uni to Euro® Connection

### 1-2

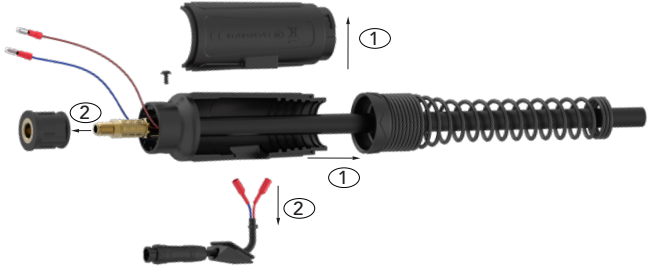

1. Remove Support, open Housing
2. Disassemble Plug Body and Male Switch Wire Plug

### 3-5

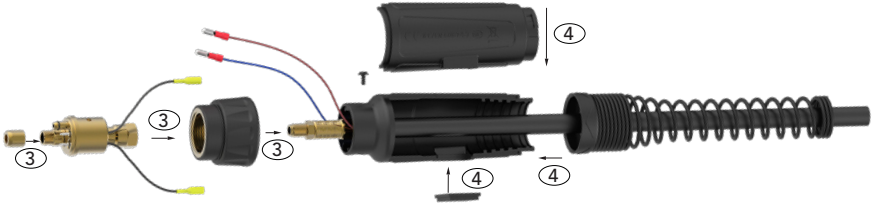

3. Assemble Nut and Euro® Body
4. Assemble Flat cover, Housing and Support

### 6



6. Complete Euro® Connection

ARC SERIES

# Make Work Life Easier

MPA025 / 2024.07



MAKE WORK  
LIFE EASIER